

Town of Bayside
P.O. Box 194
Bayside, TX. 78340
Phone: 361-529-6520 Fax: 361-529-6409
Fence Permit Application
Permit Fees: ~~\$20.00~~ plus \$.15 per foot

Date: _____ Address of Project: _____

Tenant: _____ Phone # _____ Zoning Code: _____

Please Provide the Following Information:

Description of Lot: ☐ Interior Lot ☐ Corner Lot ☐ Reverse Front Lot ☐ Pool or Spa _____

Proposed Height: Rear Yard _____ Side Yard _____ Front Yard: _____

Total Linear Feet: _____

Proposed Fence Material (PLEASE CHECK ALL THAT APPLY)

☐ Chain Link ☐ Wood ☐ Wrought Iron ☐ Masonry ☐ PVC ☐ Vinyl ☐ Other _____

Is this a required Screening Fence? ☐ Yes ☐ No

- ALL FENCES MUST MEET THE BAYSIDE FENCE BUILDING CODE ORDINANCE 70.
- NO CONSTRUCTION MAY BE STARTED UNTIL THE SETBACK INSPECTION IS APPROVED.
- IT IS THE HOMEOWNER'S RESPONSIBILITY TO ESTABLISH THE LOCATION OF THE PROPERTY LINES AND THE PROPER LOCATION OF THE FENCE. THE APPLICATION MAY BE SUBMITTED TO THE CITY SECRETARY AFTER THE SITE IS STAKED.
- APPLICATION MUST BE ACCOMPANIED BY A PLOT PLAN, DRAWING AND SPECIFICATIONS WITH REQUIRED DIMENSIONS AND IN SUFFICIENT DETAIL TO SHOW THAT WORK WILL CONFORM TO ALL APPLICABLE CITY CODES AND ORDINANCES. THIS PERMIT IS ISSUED BASED ON INFORMATION FURNISHED HEREIN AND IS SUBJECT TO PROPERTY RESTRICTIONS, PROVISIONS OF THE BUILDING CODE, ZONING ORDINANCE, FENCE ORDINANCE AND ALL OTHER GOVERNING ORDINANCES, WHICH MUST BE COMPLIED WITH, WHETHER OR NOT, HEREIN SPECIFIED. THIS PERMIT IS SUBJECT TO CANCELLATION AS PROVIDED IN THE BUILDING CODE.
- INSPECTIONS SHALL BE REQUESTED IN WRITING OR BY TELEPHONE TO THE CITY OFFICE AT LEAST FIVE (5) BUSINESS DAYS IN ADVANCE.
- IF AN INSPECTOR FINDS THAT SOME WORK DOES NOT CONFORM TO APPROVED PLANS, THE INSPECTOR WILL ADVISE (AND POSSIBLY PROVIDE WRITTEN NOTICE) THAT THE SITUATION IS TO BE REMEDIED. IF THE VIOLATION IS SERIOUS, A STOP WORK ORDER MAY BE POSTED UNTIL THE PROBLEM IS RESOLVED. ANOTHER INSPECTION MAY BE NECESSARY BEFORE WORK IS RESUMED FOR AN ADDITIONAL PERMIT FEE.
- WHEN CODE COMPLIANCE IS DETERMINED AFTER THE FINAL INSPECTION, THE CODE OFFICIAL WILL ISSUE A FINAL APPROVAL.
- WHERE WORK FOR WHICH A PERMIT IS REQUIRED BY THIS CODE IS STARTED PRIOR TO OBTAINING SAID PERMIT, A PENALTY EQUAL TO THE BUILDING PERMIT FEE SHALL BE ASSESSED. PAYMENT OF SUCH PENALTY FEE SHALL NOT RELIEVE THE PERSONS FROM FULLY COMPLYING WITH THE REQUIREMENTS OF THIS CODE IN THE EXECUTION OF THE WORK NOR FROM ANY OTHER PENALTIES PRESCRIBED HEREIN.
- ANY PERSON WHO SHALL CONTINUE ANY VIOLATION BEYOND A FIFTEEN (15) DAY PERIOD, SHALL BE GUILTY OF A MISDEMEANOR, AND ON CONVICTION THEREOF SHALL BE FINED IN THE AMOUNT NOT EXCEEDING FIVE HUNDRED DOLLARS (\$500.00) FOR EACH VIOLATION. EACH DAY THAT A VIOLATION OF THIS ORDINANCE CONTINUES SHALL CONSTITUTE A SEPARATE OFFENSE.

THIS PERMIT COVERS ONLY WORK ON PRIVATE PROPERTY AND OTHER WORK AS SPECIFICALLY MENTIONED.

Signature: _____ Date: _____

FOR OFFICE USE ONLY ☐ SETBACK INSPECTION APPROVED ☐ FINAL INSPECTION APPROVED

Receipt # _____ Amount: \$ _____ Permit # _____

Reviewed & Approved By: _____

Application Pending or Denied for the following Reasons: _____

TOWN OF BAYSIDE FENCE REGULATION DIAGRAM

**ALL FENCES MUST MEET REQUIREMENTS OF ORDINANCE 70
BAYSIDE FENCE BUILDING CODE**

**FENCES MAY NOT BE OVER SIX (6) FEET TALL IN A RESIDENTIAL ZONE
OR EIGHT (8) FEET IN A BUSINESS ZONE.
NO SOLID FENCE OVER THREE (3) FEET ALLOWED WITHIN TWENTY (20)
FEET OF PROPERTY LINE THAT ABUTS A CITY STREET. CHAIN LINK OR
WIRE MESH WITH FIFTY (50) PERCENT THROUGH VISION IS ALLOWED.**

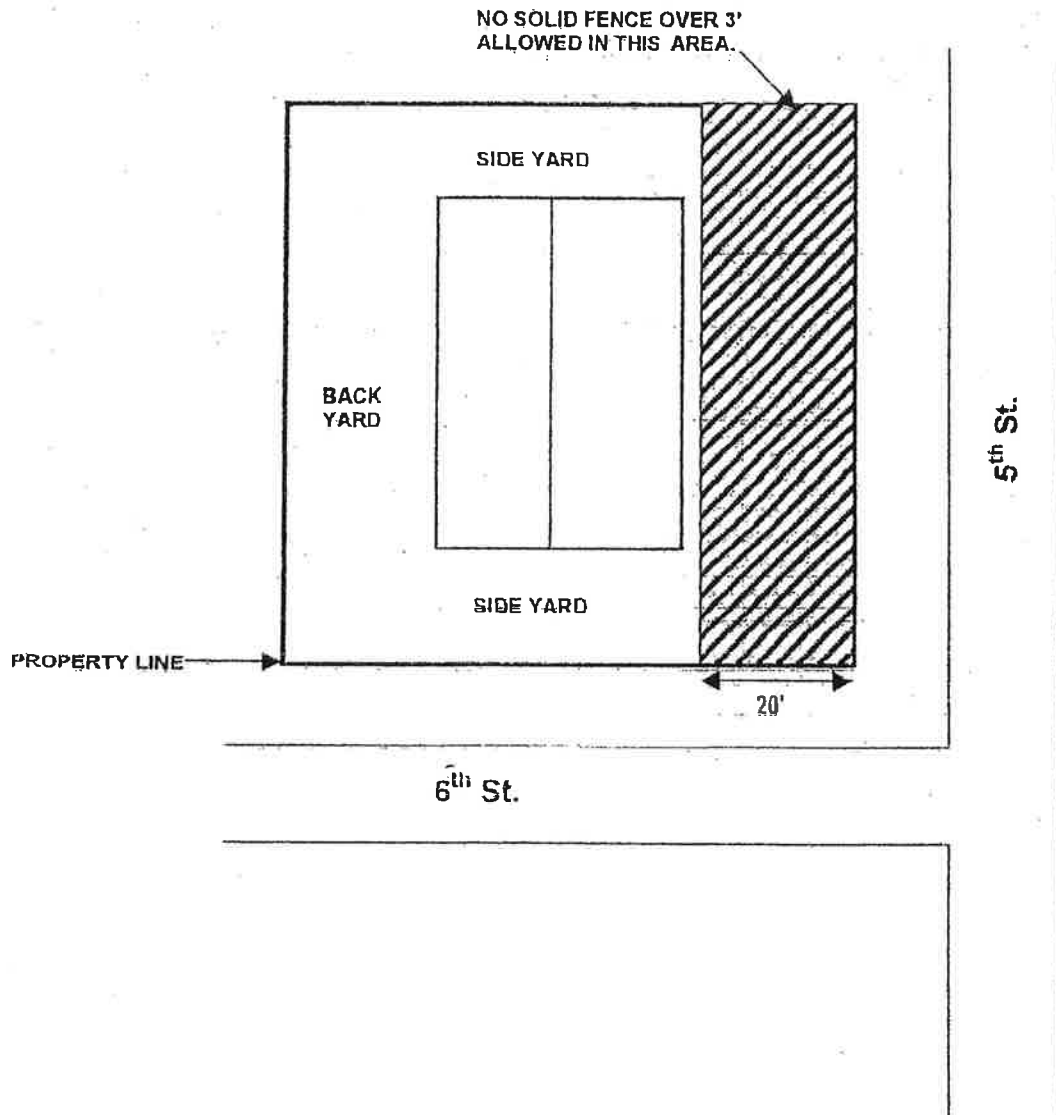

SEC.5 All swimming pools (pools having a depth of at least two (2) feet or more at any point) shall be enclosed by a fence that shall be at least four (4) feet in height of a type not readily climbed by children. However, if the entire yard of the residence is enclosed, then this provision may be waived by the Building Inspector upon inspection and approval of the yard's enclosure, or if the pool is of a portable type with a wall height of at least three (3) feet above the surrounding ground surface and of such construction as not to be readily climbed by children, then the ends of the fence may be attached to the pool structure and the fence need be erected only around the immediate area of the ladder, and other means of access to the pool. Gates shall be of a self-closing latch type with the latch on the inside of the gate, not readily available for children to open. Pools constructed or erected after the date of this Ordinance shall be enclosed by such a fence before water is placed in the pool. Pools which have been constructed or erected prior to the date of this Ordinance shall be enclosed by such a fence on or before August 1, 2003.

SEC. 6 Manufactured housing parks and recreational vehicle or travel trailer parks shall be enclosed by a screening or solid fence that shall be at least eight (8) feet in height.

ARTICLE XI FENCE MATERIALS

SEC. 1 No sheet metal, chicken wire, barbed wire, concertina wire or razor wire fences, products manufactured for other uses as plywood, corrugated steel or fiberglass panels shall be permitted on any residential lot. It is unlawful for any person to erect, maintain, or permit a fence that has in it or on it barbs, projections, broken glass, or anything reasonably capable of causing harm to persons or animals.

SEC. 2 The minimum size wire mesh for chain link or woven wire fence shall be not less than two (2) inches.

SEC. 3 It is an affirmative defense to Section 1 of this Article that the fence is situated in a non-residentially zoned area and that the barbed wire, concertina wire, razor wire, barbs, projections, broken glass, or anything reasonably capable of causing harm to persons or animals is on a portion of the fence that is more than six (6) feet above the grade measured no more than eighteen (18) inches either side of the fence, and not over public right-of-way, easement, or private property of a person who is not the owner of the fence. If the fence is next to property that is residentially zoned, it is an affirmative defense to Section 1 of this Article that the barbed wire, concertina wire, razor wire, barbs, projections, broken glass, or anything reasonably capable of causing harm to persons or animals is on an arm extending inward.

ARTICLE XII ENCROACHMENT ON PUBLIC PROPERTY.

No fence, guy wires, braces or any post of such fence shall be constructed upon or cause or protrude over property that the city or that the general public has dominion and control over, owns or has an easement over, under, around or through, except upon utility easements which are permitted to be fenced.